

**TR**

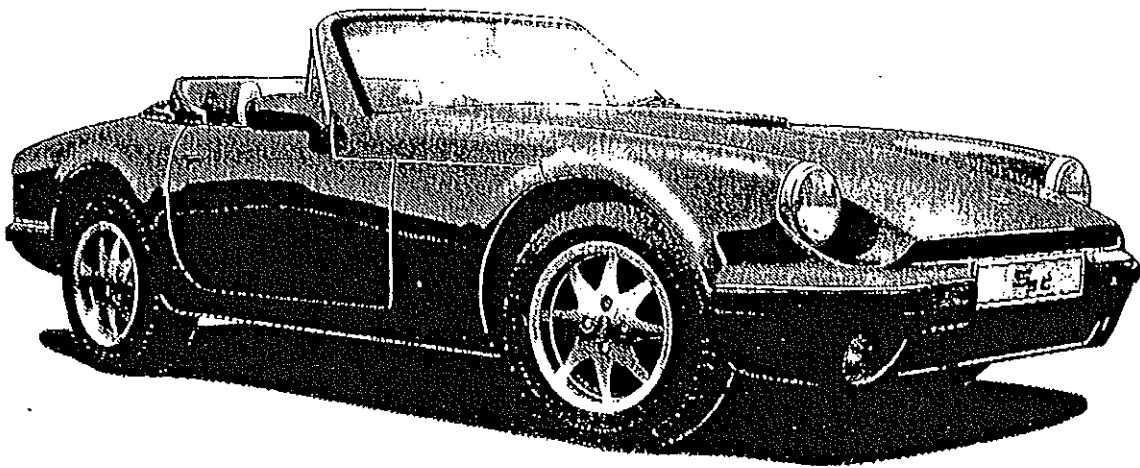

Parts Catalogue  
Section L Fuel System

**S**  
SERIES

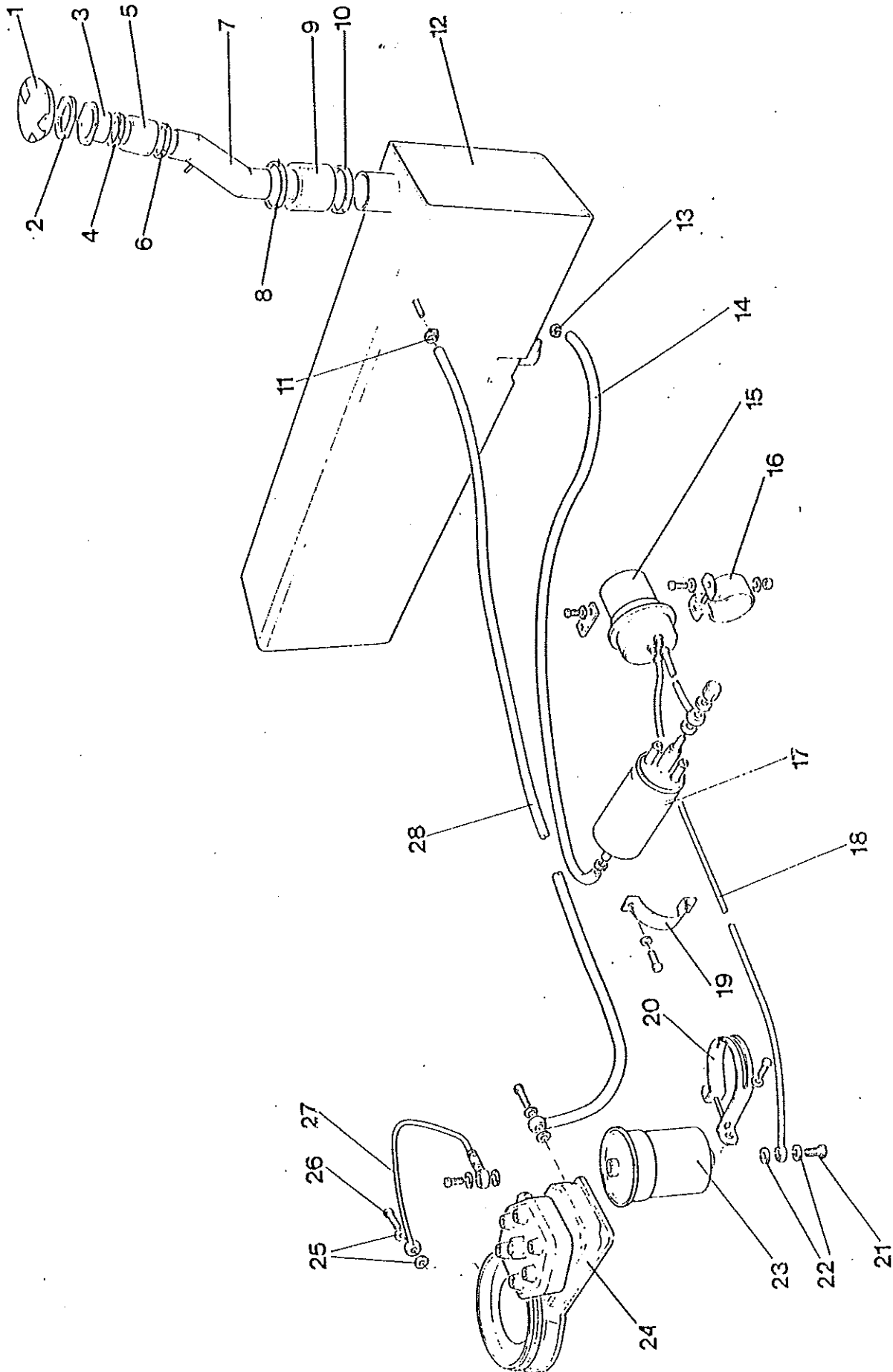

THERE IS NO FACTORY ISSUED PARTS  
SCHEDULE FOR FUEL, SYSTEM L1



# TVR Engineering Limited Parts Catalogue

Section L2 Fuel System

Comments :

Date of Issue :Feb. 1991

Date Revised :

Drawing Ref :

Item	Part No.	Description	Qty
1	S28L 10024	Fuel Tank (Early Spec-To 12/12/90 Chassis SDL DSC2P7ML011154 Finish)	1
1	S29L 10038	Fuel Tank (Late Spec-From 12/12/90 Chassis SDL DSC2P9ML011155 Begin)	1
2	S28L 10025	Fuel Sender (Early Spec-To 12/12/90 Chassis SDL DSC2P7ML011154 Finish S.W.Type)	1
2	S29L 10039	Fuel Sender (Late Spec-From 12/12/90 Chassis SDL DSC2P9ML011155 Begin) (L.A.P.Type)	1
3	O35L 163A	Rubber 'O' Ring	2
4	O35L 162A	Metal Locking Ring	2
5	S29L 10042	Fuel Pump	1
6	S28L 10023	Fuel Filter	1
7	S28L 10017	Rubber Sleeve, Filler Neck 2 1/4" I.D. 8 - 6" Long	2
8	O25W 075A	Jubilee Clip (60-80mm)	4
9	S28L 10018	'Z' Pipe, Filler Neck	1
10	S29L 10037	Plate, Tank Base	1
14	S29L 10043	Fuel Damper	1
15	O25J 044A	'P' Clip (Catalyst only)	1
16	S29L 10044	Clip. Fuel Pipe Rail (Catalyst only)	1
17	S29L 10045	Map Sensor (Catalyst only)	1
18	S29L 10058	Locating Bracket, Fuel Pump	1
19	S29L 10059	Locating Bracket, Fuel Filter	1
20	S29L 10046	Carbon Cannister (Catalyst only)	1
21	S29L 10047	Carbon Cannister Bracket (Catalyst only)	1
22	S29L 10048	Fuel Pressure Regulator (Catalyst only)	1
23	S29L 10049	Fuel Pressure Regulator Boot (Catalyst only)	1
24	S29L 10050	Hose, Damper To Pump	1
25	O25W 072A	Clip (16 - 27mm)	2

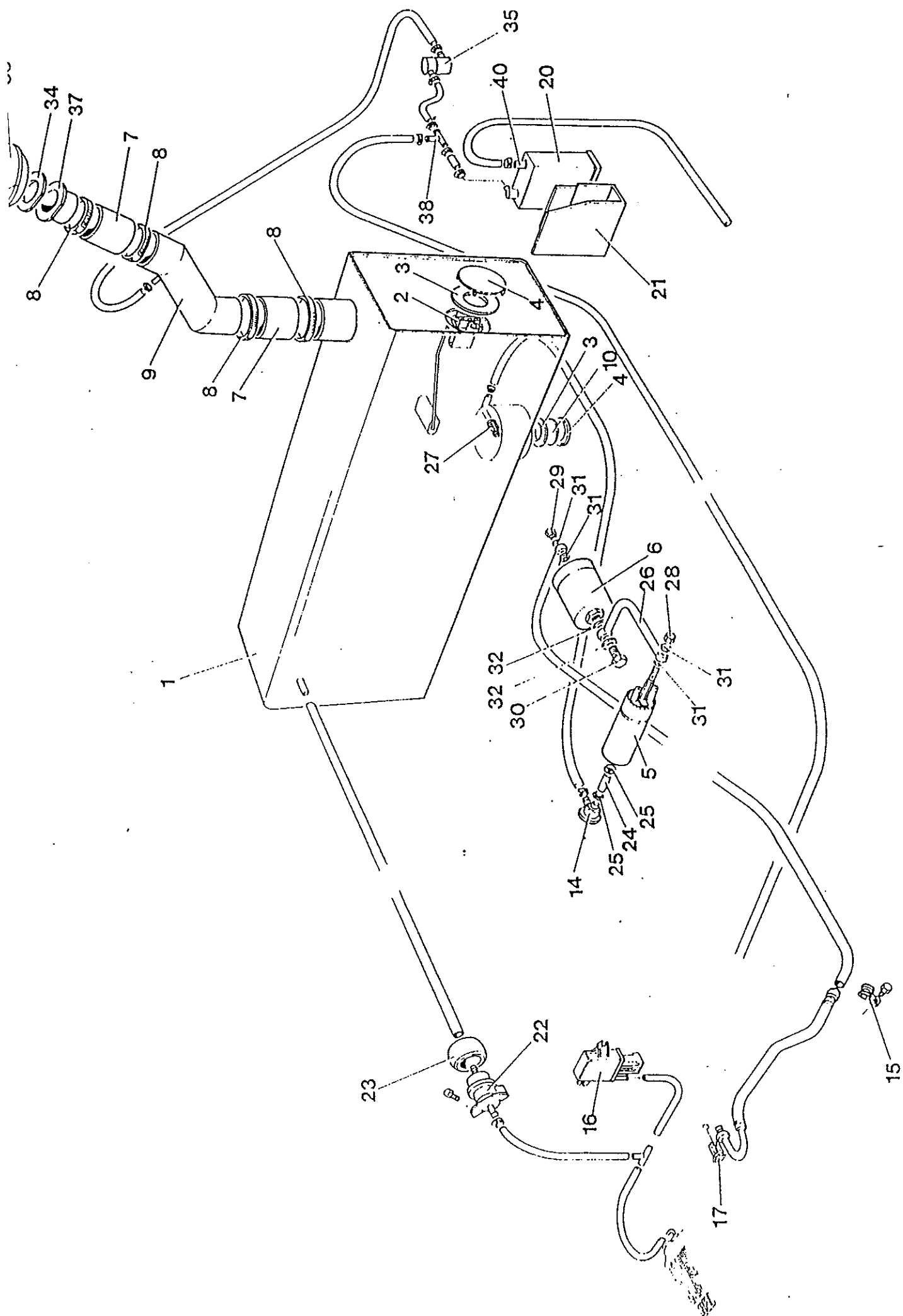

**TVR Engineering Limited Parts Catalogue**

Section            L2      Fuel System-Cont/d

Comments

Date of Issue :Feb.1991      Date Revised :      Drawing Ref.:

Item	Part No.	Description	Qty
26		Hose. Pump To Filter	1
27		Gauze. Fuel Tank	1
28		Domed Nut	1
29		Banjo Bolt. Small M12 x 1.5 x 24	1
30		Banjo Bolt. Large M14 x 1.5 x 26	1
31		Sealing Copper Washer. Small M12 x 1.5 x 16	4
32		Sealing Copper Washer. Large M14 x 1.5 x 19	2
33	S28L 10033	Fuel Filter Cap. Chrome. Non-Locking	1
34	S28L 10010	Gasket. Filler Neck To Body	1
35	I25L 115A	Roll Over Valve (Catalyst only).	1
36	S29L 10035	Lead Free Sticker. Fuel Cap (Catalyst only)	1
37	S28L 10009	Neck Base	1
38	T45L 005R	"T" Piece (Catalyst only)	1
39	S28L 10030	Fuel Pipe (NRL 40) 2m (Catalyst only)	2m
40	O35K 114A	Reducer (19-8mm Catalyst only)	1

